

1st Floor

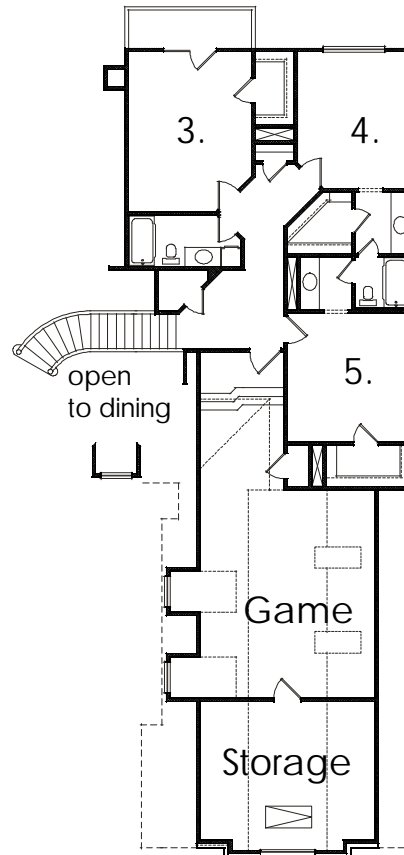

2nd Floor

The Rothwell

Rooms with a view! This home has a beautiful dining room with a vaulted ceiling that displays the grand stair. The family room, breakfast area and kitchen create the perfect casual living area for families. Other features include a study with a barrel vaulted ceiling and a large game room over the garage.



Floor plans & elevations are subject to change and dimensions are approximate. Purchasers are advised consult their state and local building authorities and a state certified architect prior to any construction related to these plans.
© Copyright 1998

Specifications

1st floor	2,422
2nd floor	1,473

Total Living Area 3,895 Sq. Ft.

5 Bedrooms, 4 Baths, 3 Living Areas
58'-10" Wide x 78'-10" Deep

1st Floor

Study 13' x 14'
Family Room 15'-4" x 20'-2"
Dining Room 13'-0" x 11'-10"
Kitchen 13'-4" x 13'-10"
Breakfast 11'-6" x 12'-8"
Master Bedroom 14'-8" x 19'-0"
Bedroom #2 11'-4" x 12'-4"

2nd Floor

Bedroom #2 12' x 15'-7"
Bedroom #3 10'-11" x 13'-4"
Bedroom #4 11'-11" x 12'-6"
Game Room 17' x 20'